



BUGANDA KINGDOM



Why Partner With The Kingdom?

INVESTMENT PROFILE



“creating
new values”

Introduction

1.0

Buganda Kingdom is the largest of the traditional kingdoms in presentday Uganda, comprising all of Uganda's Central Region, including the Ugandan capital Kampala with the present population of about ten million Baganda.

The Kingdom is one of the most organized Kingdoms in Africa with a well established traditional administrative structure with the Kabaka at its apex and the administrative and clan chiefs down the structure.

The central position of the king of Buganda among the Baganda has created a strong attachment between the King and his people.

Below are highlights of the reasons on why you should partner with the Buganda Kingdom;

- ❑ Buganda Kingdom is the most organized, most recognized and the oldest Kingdom in Uganda
- ❑ It's people the Baganda constitute 25% of the Ugandan population approximately 10 million people
- ❑ Buganda as a region (including other tribes) is close to 40% of the population
- ❑ 70% of business sales or goods and services happen within a radius of 50-80kms from Kampala which is ALL Buganda
- ❑ The Passion, Love and Loyalty of the people of Buganda for their King and Kingdom is in their "DNA". You will have guaranteed access to this segment of market.

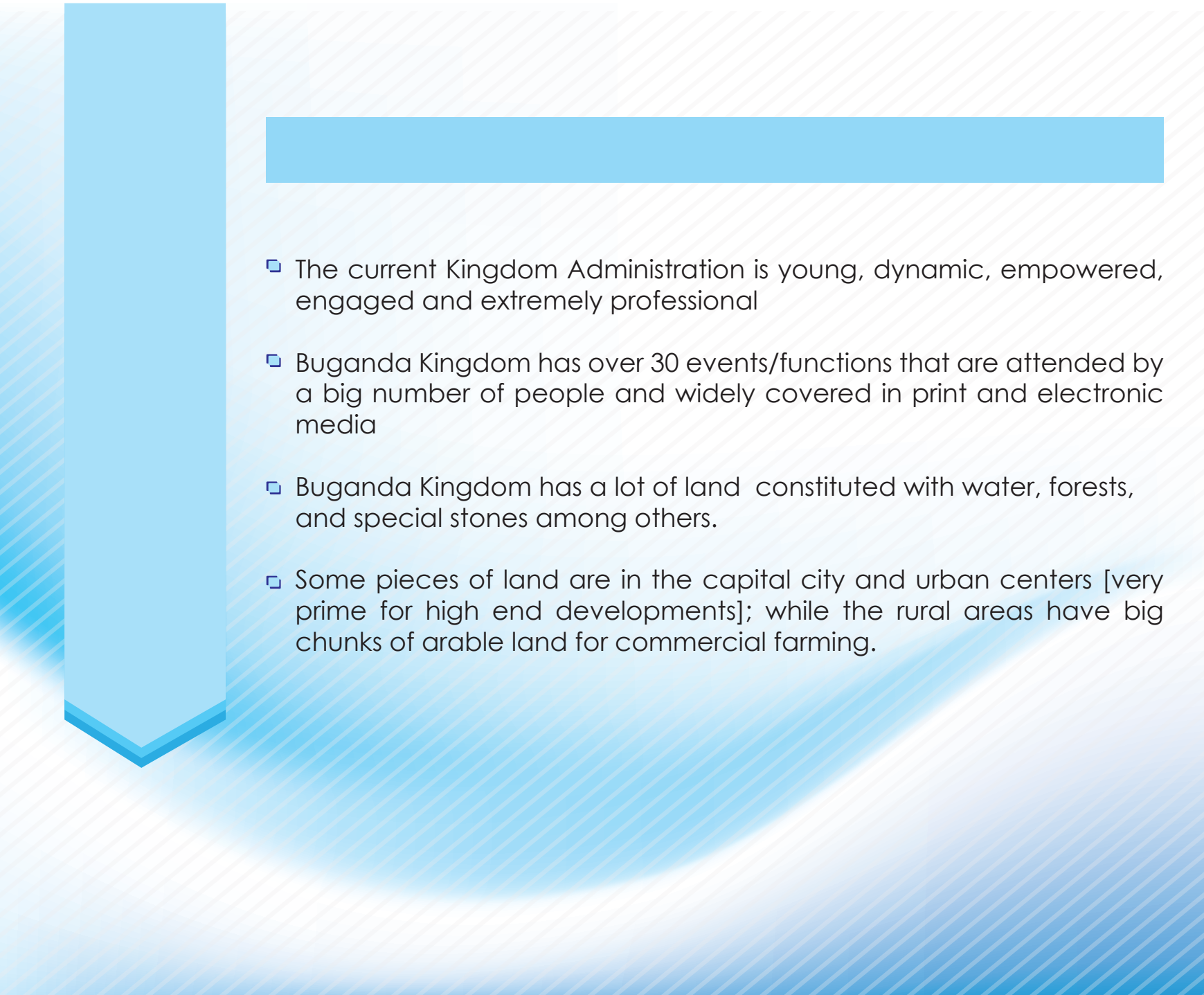
- 
- ❑ The current Kingdom Administration is young, dynamic, empowered, engaged and extremely professional
 - ❑ Buganda Kingdom has over 30 events/functions that are attended by a big number of people and widely covered in print and electronic media
 - ❑ Buganda Kingdom has a lot of land constituted with water, forests, and special stones among others.
 - ❑ Some pieces of land are in the capital city and urban centers [very prime for high end developments]; while the rural areas have big chunks of arable land for commercial farming.

I) Granite Rock Outcrops

Buganda Kingdom has Huge deposits of quality granite stone outcrops which can be used for making hard core granite tiles, fabrication of kitchen/table counter tops, Tombstones, bathroom vanity tops, Jacuzzi and fireplace surrounds, stone aggregate for road construction and reinforcing buildings. (See tables attached)

Quantity of extractable material 9.4million tones at Nammonde granite rock

Out crop 1	Out crop 2	Out crop 3
Area: 21,000m2	38,000m2	48,000m2
Comp: Pink medium Well foliated granite	Non foliated granite	Medium grained granite
Vol: 20,000m3	37,000m3	48,000m3

The granite genesis rock at Nakanyonyi, Nabbaale Kyaggwe block 40 reserve estimation

OUTCROPS	MAIN	LOWER 1	LOWER 2
Area (m2)	79,256	42,845	12,152
Depth of extraction (masl)	1,153	1,140	1,160
Total	Reserves	including	
overburden (m3)	2,411,987	980,828	170,387
Overburden & weathered portion (%)	30	30	60
Overburden (m3)	723,596	294,248	102,232
Ore reserve (m3) (a--b)	1,688,391	686,579	68,155
Ore reserve extraction (80% of total reserve)	1,350,713	549,262	54,524
Tonnage, tonnes (specific gravity=2.6 tonnes per m3=2.6*c	3,511,853	1,428,085	141,762

NOTE: The detailed geological reports on the above rock deposits can be accessed on request.



Granite Rock



ii) Commercial and Residential Developments

The Kingdom has various parcels of land that can be used for commercial and residential real estate projects. Plots of land ranging from ½-10 acres exist around Katwe, Makindye and Mengo areas. All these are very prime areas with less than 8km to the Central Business District thus viable for commercial development.



.Commercial

- Master Planned Area in Katwe next to Muganzirwazza (5 Acres)



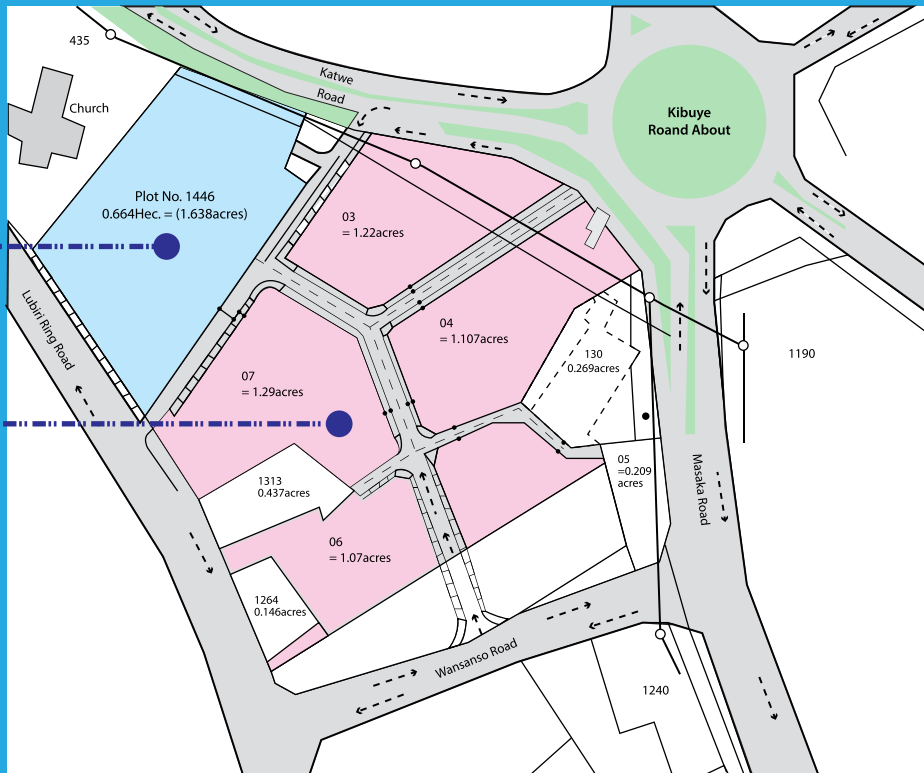
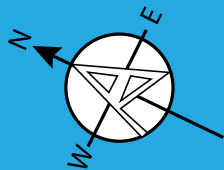

Proposed Development



Present Day **SLUM AREA**



Nakulabye Corner plot (1.5 Acres)

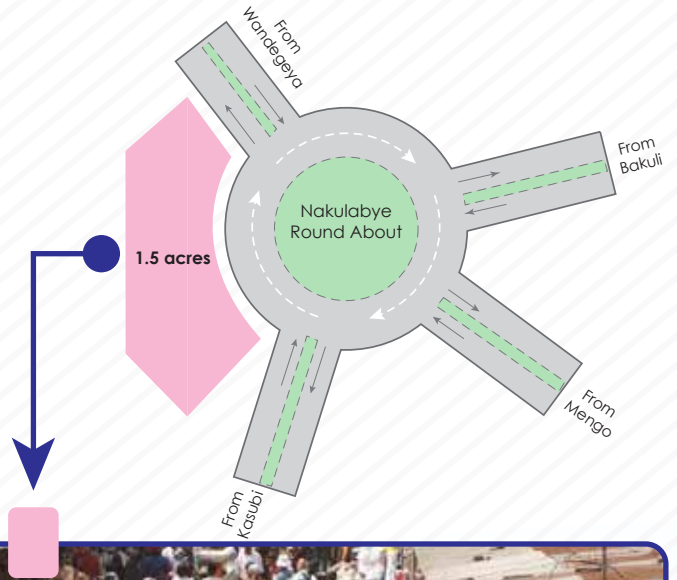

Present day **Nakulabye Market**



Residential

- KIGO Penninsula (257 acres)

The area is proposed to be a high end residential neighborhood whose proximity to a 19 hole golf course of Lake Victoria Serena hotel and the fascinating lake view compares to none.

Aerial view of the Proposed Master Plan



NOTE: A detailed master plan can be shared with a prospective investor.

Seventy (70) acres of this land have so far been committed to a developer under the Kingdom Private Partnership arrangement, with such residential houses planned.



Proposed



Residential Homes

Low Cost Housing

III) Low Cost Housing

Land for a Mass Housing Project in Buswa, Wakiso District.

The mass housing project would fill the gap in the housing sector. According to Uganda Bureau of Statistics (UBOS), Uganda has a housing deficit of 550,000 units. About 160,000 of this backlog is in urban areas. Kampala alone has a housing deficit of 100,000 units.



Low Cost Housing

Kabaka's Lake

This five acre lake on the outskirts of Kampala was created during the reign of Kabaka Mwanga in the 1880s for his personal enjoyment, as he enjoyed swimming and fishing.

The plan of the king was to construct a channel wide enough for him to travel by boat to Lake Victoria for swimming and fishing and staying at another palace he had built at Mulungu hill near Lake Victoria. The channel would also serve as an escape waterway in the event of armed conflict with the British.

Kabaka's Lake is now one of the tourist attraction sites in Kampala and it's the biggest man-made lake in Uganda.

Site Location

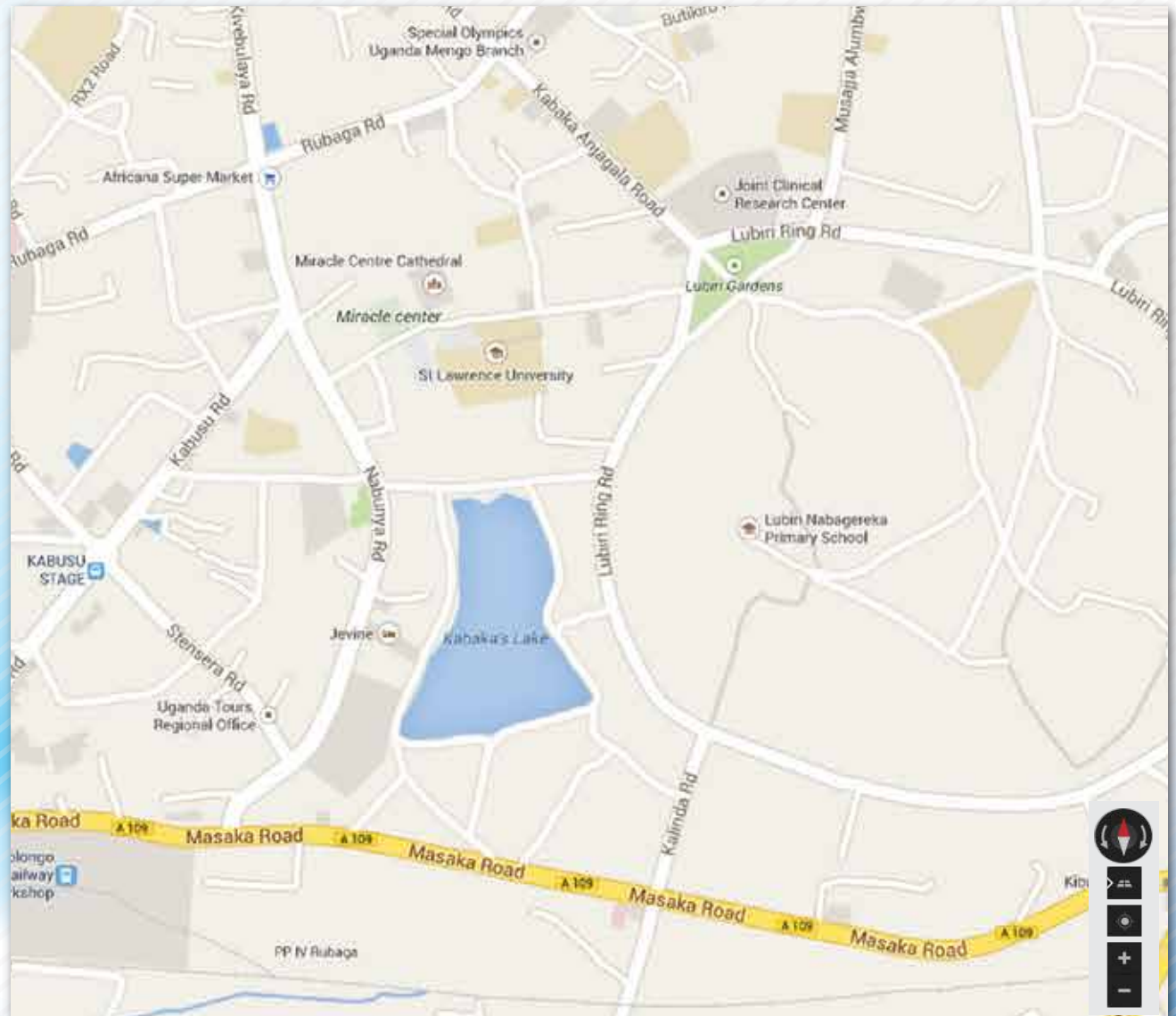

A wide, calm lake with a grassy bank in the foreground and a residential area in the background. The water is still, reflecting the sky and the surrounding greenery. In the foreground, there are lush green plants and grass. In the background, there are several buildings, including a prominent white multi-story building, and a line of trees. The sky is clear and blue.

Kabaka's Lake



Fitness walk ways



Restaurants



Water Sport

Commercial Agriculture

IV) Commercial Agriculture

There is land available for agricultural purposes in Kyaggwe and Buddu. The Ministry of Agriculture has done the mapping for the appropriate crops that can be grown in each of these areas. The land is arable with flowing fresh water streams of River Nile for Kyaggwe and Lake Victoria for Buddu which would facilitate irrigation.



Commercial Agriculture

Media

V) Media

The Kingdom has a radio with the most listenership in the country and wishes to partner with interested companies to establish a vernacular newspaper and television.

K2 Telecom

Buganda Kingdom has stake in one of the most recent entrant in the telecommunication industry K2 Telecom.

The vision of this telecom company is to enable social-economic development through provision of reliable, quality and affordable telecom services.



Media



Bulange
Mengo



Contact Us

Buganda Investments and Commercial Undertakings Limited (BICUL)
Ministry Of Investments Planning & Economic Development
Bulange Mengo P.O.Box 7451 Kampala
Tel: +256-412-74738/9 | Mob: +256-730-400208
Email: sebuwufu@bicul.co.ug
Websites: www.buganda.or.ug | www.bicul.co.ug